

Residential Development Site, The Former Woodman, Leys Road, Brierley Hill DY5

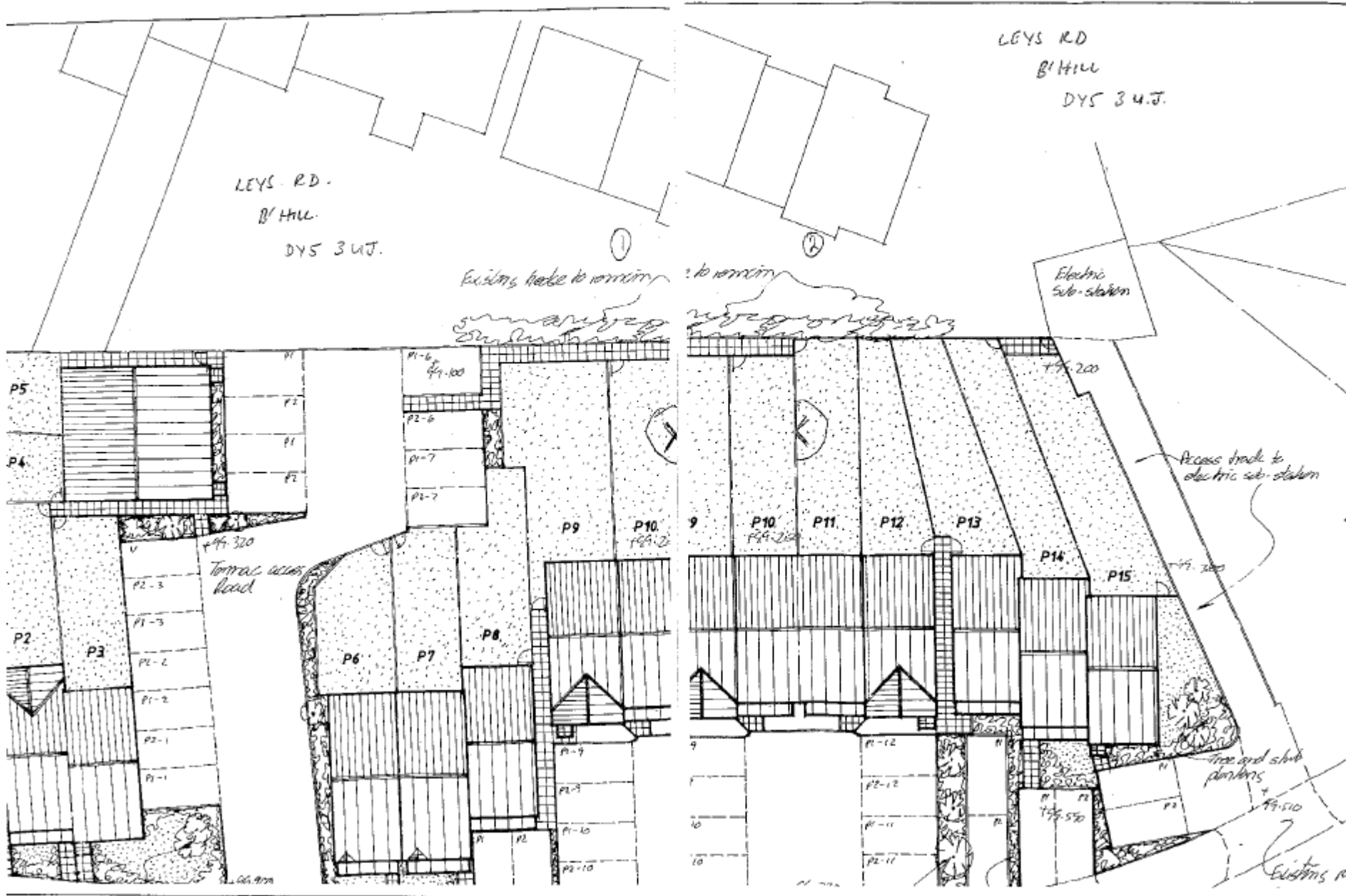





General Information

This development site (formally the Woodman Public House sits on an area of cleared land 0.62 acres approximately.

In the past the current owners sought to obtain a planning consent for 15 dwellings (previous application ref P08/1841) However the owners withdrew the application back in 2008 to sort out issues regarding bowling greens at the time.

In light of policy changes and now that this is a cleared site we are confident that any suitable application would be treated favourably.

Local Authority

Dudley Metropolitan Borough Council
Planning and Economic Development
Directorate of PLACE
4 Ednam Road
Dudley
West Midlands
DY1 1HL

Tel: 01384 814155

For Further Information:

Contact: Paul Davis
Tel: 01384 623557
Email: paul@paramountipc.co.uk

Price: **Offers Invited**

Terms & Conditions: Purchasers will be responsible for T&C's to include fees —details upon request

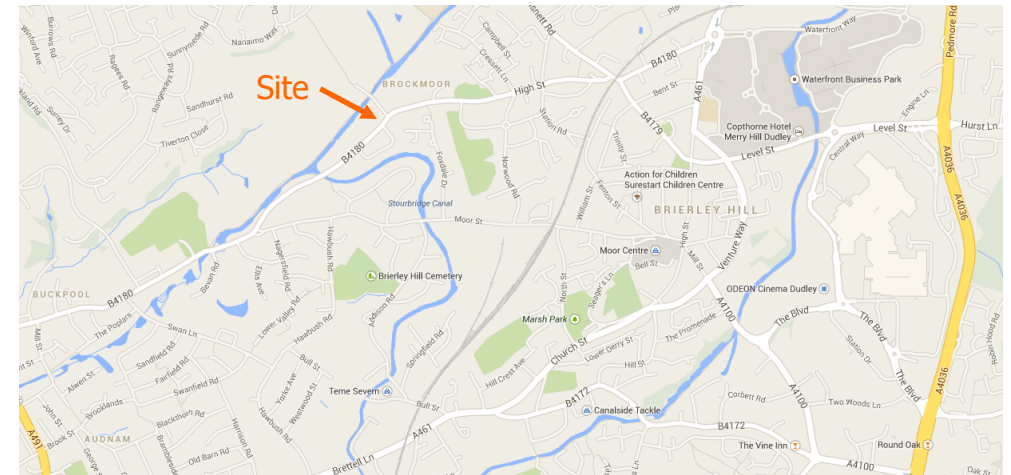

PROPERTY MISDESCRIPTIONS ACT 1991

these particulars maybe subject to errors. While we endeavour to make all details accurate, prospective purchasers are advised to satisfy themselves by inspection or otherwise as to their accuracy and correctness. Paramount Land & Property Consultants DO NOT GIVE ANY WARRANTY TO THE ACCURACY OF ANY MEASUREMENT, TEXT OR PHOTOGRAPH AND INTERESTED PARTIES SHOULD NOT RELY UPON ANY INFORMATION WITHIN THESE DETAILS.

IMPORTANT

Paramount Land & Property Consultants have not been able to confirm the availability of services such as the gas, water, electricity and drainage to these properties. We advise that all interested parties should obtain verification through their solicitor or surveyor before entering any legal commitment. Paramount Land & Property Consultants have not tested the working order of the heating system in these properties, we advise all interested parties to check before entering any legal commitment. PLEASE NOTE THAT ITEMS IN THE PHOTOGRAPH'S MAY NOT BE INCLUDED IN THE SALE. PLEASE VERIFY ALL FIXTURES AND FITTINGS THROUGH YOUR LEGAL REPRESENTATIVE